

# JUNO PL / JUNO PL BLE LED / LED<sup>IQ</sup>

oktalite

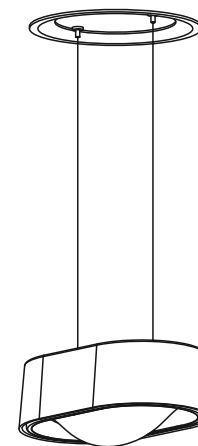
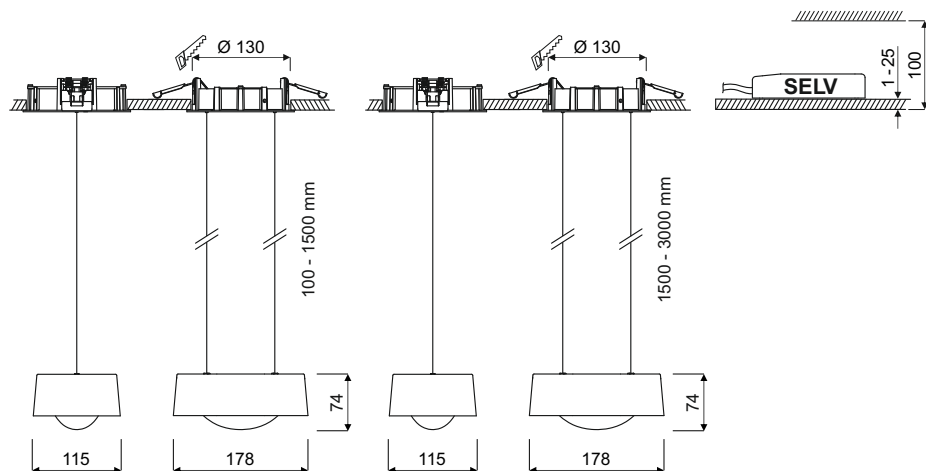

## VEREINFACHTE EU-KONFORMITÄTSERKLÄRUNG

Hiermit erklärt Oktalite Lichttechnik GmbH, dass der Funkanlagentyp JUNO PL BLE der Richtlinie 2014/53/EU entspricht. Der vollständige Text der EU-Konformitätserklärung ist unter der folgenden Internetadresse verfügbar: <https://www.oktalite.com/downloads>

## SIMPLIFIED EU DECLARATION OF CONFORMITY

Hereby, Oktalite Lichttechnik GmbH declares that the radio equipment type JUNO PL BLE is in compliance with Directive 2014/53/EU. The full text of the EU declaration of conformity is available at the following internet address: <https://www.oktalite.com/downloads>

## DECLARATION UE DE CONFORMITE SIMPLIFIEE

Le soussigné, Oktalite Lichttechnik GmbH, déclare que l'équipement radioélectrique du type JUNO PL BLE est conforme à la directive 2014/53/UE. Le texte complet de la déclaration UE de conformité est disponible à l'adresse internet suivante: <https://www.oktalite.com/downloads>

## DICHIARAZIONE DI CONFORMITÀ UE SEMPLIFICATA

Il fabbricante, Oktalite Lichttechnik GmbH, dichiara che il tipo di apparecchiatura radio JUNO PL BLE è conforme alla direttiva 2014/53/UE. Il testo completo della dichiarazione di conformità UE è disponibile al seguente indirizzo Internet: <https://www.oktalite.com/downloads>

## DECLARACIÓN UE DE CONFORMIDAD SIMPLIFICADA

Por la presente, Oktalite Lichttechnik GmbH declara que el tipo de equipo radioeléctrico JUNO PL BLE es conforme con la Directiva 2014/53/UE. El texto completo de la declaración UE de conformidad está disponible en la dirección Internet siguiente: <https://www.oktalite.com/downloads>

Oktalite Lichttechnik GmbH  
Mathias-Brüggen-Straße 73  
50829 Köln, Germany  
T +49 221 59767-0  
F +49 221 59767-40  
mail@oktalite.com  
www.oktalite.com

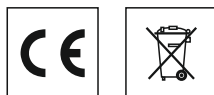

© Oktalite Lichttechnik GmbH, 2021

## JUNO PL / JUNO PL BLE LED / LED<sup>IQ</sup>

- DE Montageanleitung
- EN Installation instructions
- FR Notice de montage
- IT Istruzioni per il montaggio
- ES Instrucciones de montaje
- RU Инструкция по монтажу



TK 10232706 · 20072211-01

# JUNO PL / JUNO PL BLE LED / LED<sup>IQ</sup>

**DE** Hierzu gehören die allgemeinen Montagehinweise TK 10166740. Vor Montage/Inbetriebnahme die Anleitungen lesen. Technische Änderungen vorbehalten!

**EN** This includes the general installation instructions TK 10166740. Before mounting/putting into operation read the instructions. Subject to technical changes!

**FR** En font partie les instructions générales de montage TK 10166740. Lire les instructions avant le montage/mise en service. Sous réserve de toute modification technique !

**IT** Ne fanno parte le istruzioni generali per il montaggio TK 10166740. Leggere le istruzioni prima del montaggio/della messa in esercizio. Con riserva di modifiche tecniche!

**ES** Aquí corresponden las indicaciones generales de montaje del modelo con el TK 10166740. Lea las instrucciones antes del montaje/puesta en funcionamiento. Nos reservamos el derecho de realizar modificaciones técnicas.

**RU** К ним относятся общие инструкции по установке ТК 10166740. Прочитайте инструкцию перед установкой / вводом в эксплуатацию. Мы оставляем за собой право на технические изменения!

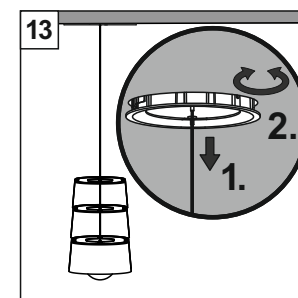
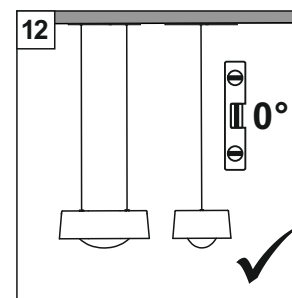
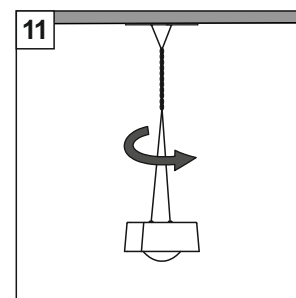
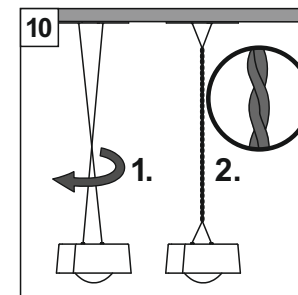
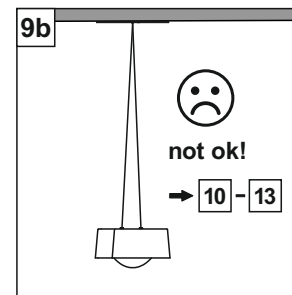
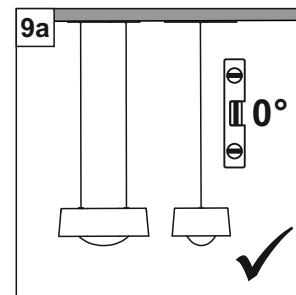
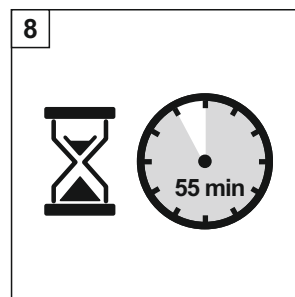
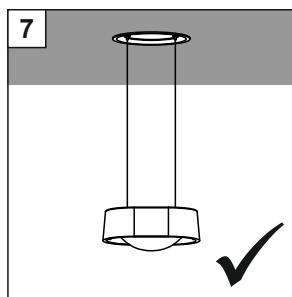
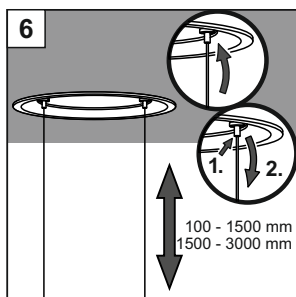
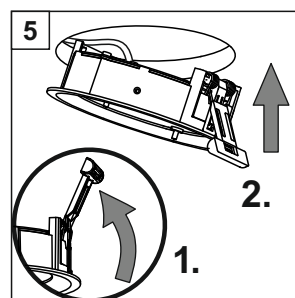
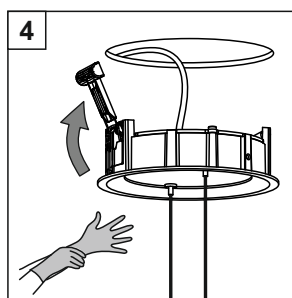
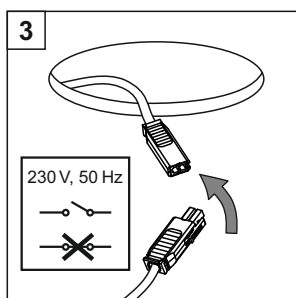
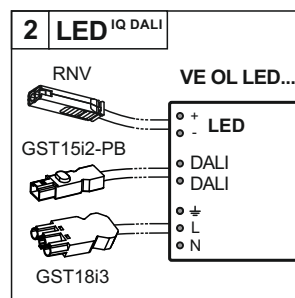
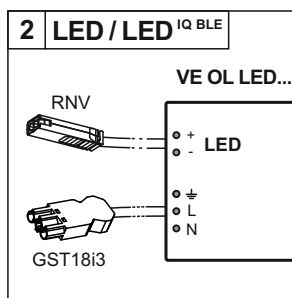
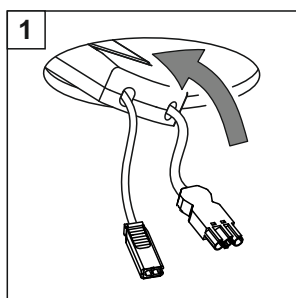

**DE** Demontage der Leuchte

**EN** Disassembly of the luminaire

**FR** Démontage du luminaire

**IT** Smontaggio dei faretto

**ES** Desmontaje de la luminaria

**RU** Демонтаж светильника

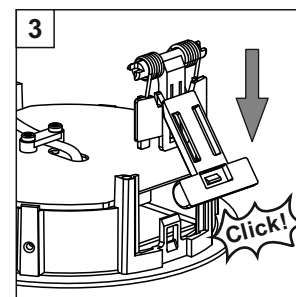
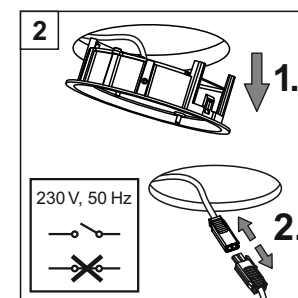
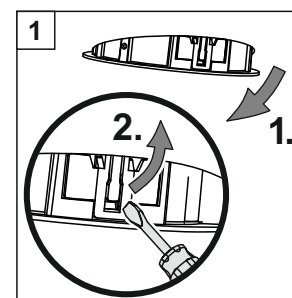

**DE** Ersatzeinbaufedern (2er Set)

**EN** Spare mounting springs (2 pc. Set)

**FR** Ressorts de montage de rechange (jeu de 2)

**IT** Molla a incasso di ricambio (set da 2)

**ES** Muelles de montaje de repuesto (kit de 2 unidades)

**RU** Запасные пружины для монтажа (комплект 2 шт.)

